

VP6000 SPECIFICATION

Version	Date	Reason
V1.5	10/12/2017	Document

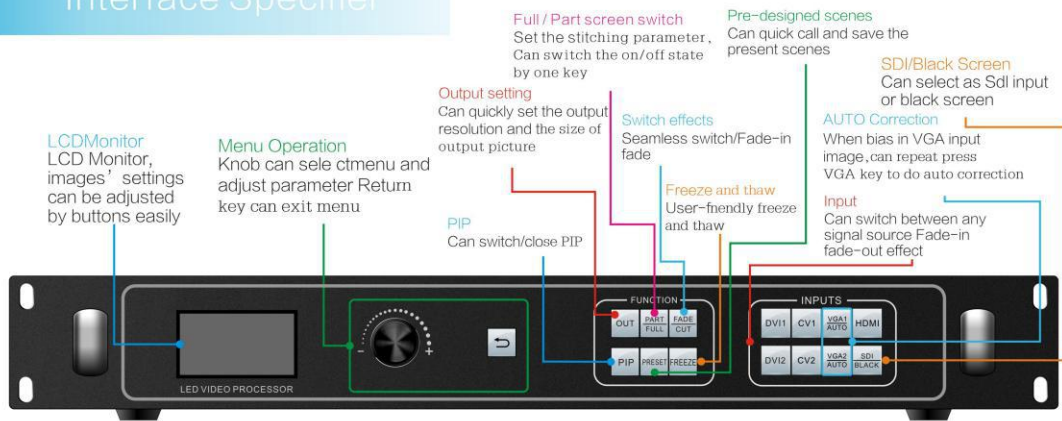

Interface Specifier



Face

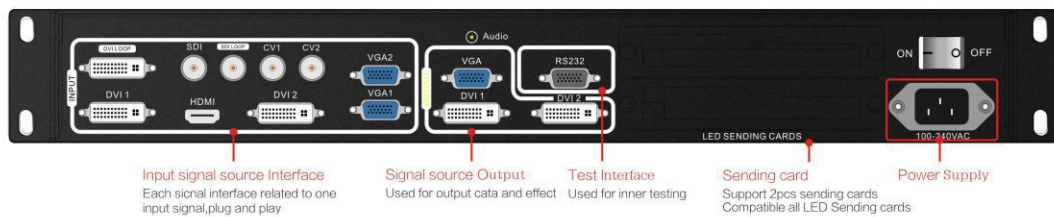

Back

LS-VP6000 CONNECTION SKETCH

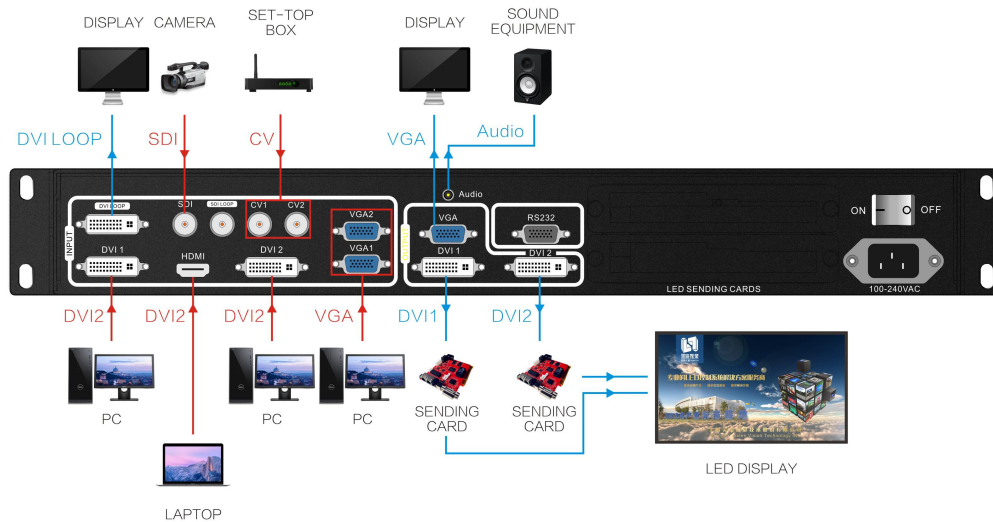

Product Features

LS-VP6000 LED Video Processor , has 7 channels of video input, 3 channels of video output, 1 channel of audio output , It can be widely used in engineering, rental performance, irregular/large LED display screen/mixed LED display (different spacing), large stage theater, display and exhibition, etc.

Multiple video interface	Input has HDMI, 2*DVI, 2*VGA, 2*CVBS, SDI(optional) Output has 2*DVI, VGA
Seamless switching/Fade-in-fade-out	Pictures from 2 channels can be switched seamless, also can be fade-in-fade-out
Multiple output resolution	Multiple output resolution(fixed)(max2304x1152@60Hz) and custom resolution
2.65 pixel	max 3,840 pixel horizontally and 1920 pixel vertically
Audio and video synchronous	Synchronization of audio and video switching
Chroma Key	Cut part image from one video ,then put it on another video, for example image overlapped
Support picture in picture (PIP)	The size and location of the 2 pictures can be adjustable
Powerful Splicing function	Perfectly splicing,support Uniform and not uniform splicing, support 10X10 video processors to splicing
Custom input resolution	Can perfectly realize the PC to LED screen point to point display
Support project lock settings	To avoid the wrong operation
Short key settings	Black output/Normal output,Freeze, Part/Full Screen

DVI video input

Input quantity	2
Connector	DVI-I socket
Signal standard	DVI1.0 , HDMI1.3 downward compatible
Resolution	VESA , PC to 1920x1200 , HD to 1080p

HDMI video input

Input quantity	1
Connector	HDMI-A
Signal standard	HDMI1.3downward compatible
Resolution	VESA , PC to 1920x1200 , HD to 1080p

VGA video input

Input quantity	2
Connector	DB15 socket
Signal standard	R、 G、 B、 Hsync、 Vsync:0 to1Vpp±3dB (0.7V Video+0.3v Sync) 75 ohm black level : 300mV Sync-tip : 0V
Resolution	VESA, PC to 1920x1200

Compoud video input (CVBS)

Input quantity	2
Connector	BNC
Signal standard	PAL/NTSC 1Vpp±3db (0.7V Video+0.3v Sync) 75 ohm
Resolution	480i,576i

※ SDI video input (option)

Input quantity	1
Connector	BNC
Signal standard	SD/HD/3G-SDI
Resolution	1080p 60/50/30/25/24/25(PsF)/24(PsF)720p 60/50/25/24 1080i 1035i 625/525 line

※audio output

Input quantity	1
Connector	RCA
Signal standard	Analog audio

DVI loop out

Output quantity	1
Connector	DVI-I socket
Signal standard	DVI1.0 , HDMI1.3 backward compatible
Resolution	VESA , PC to 1920x1200 , HD to 1080p

DVI/VGA video output

Output quantity	2 DVI, 1VGA		
Connector	DVI-I socket, DB15 socket		
Signal standard	DVI : DVI1.0	VGA : VESA	
Resolution		1920×1080@60H	
		Z	2304×1152@60H
		1920×1200@60H	Z
	1024×768@60Hz	Z	1280×720@50Hz
	1280×720@60Hz	1024×1280@60H	1920×1080@50H
	1280×1024@60Hz	Z	Z
	1440×900@60Hz	1536×1536@60H	1024×1920@60H
	1600×1200@60Hz	Z	Z
	1680×1050@60Hz	2046×640@60Hz	Z
		2048×1152@60H	Custom
	Z		

Whole machine

Weight	3.5kg
Size (mm)	Cabinet size : (LWH) 303×484×60 Package size : (LWH) 510×131×363.5
Input power	100VAC – 240VAC 50/60Hz
Max power	18W
Working temperature	0°C ~ 45°C
Storage humidity	10% ~ 90%